

Summary

This beautiful cottage is situated in the heart of the popular village of Kedington, perfectly blending modern amenities with a wealth of character and charm. With two double bedrooms, the property has been lovingly improved including stunning double glazed sash windows & new energy efficient electric radiators.

Description

Approximate Room Sizes

THE PROPERTY This beautiful cottage is situated in the heart of the popular village of Kedington, perfectly blending modern amenities with a wealth of character and charm. As you approach the property, you'll immediately be drawn to its kerb appeal. The home stands proudly behind a stone wall, with a decorative iron gate providing access to the front garden. This garden is mainly paved, featuring a pathway leading to the front door. The owner has also recently installed double glazed sash windows, which maintain the classic nature of the home while offering the benefit of modern efficiency. On top of this, the owner has installed energy efficient electric radiators.

Step inside into a spacious hallway, complete with stairs leading to the first floor and doors to all internal rooms. The lounge is a beautiful and cosy room centered around a feature fireplace with a log burner. Exposed beams and wall lighting add to the character of this inviting space. The kitchen/diner is another lovely room that perfectly blends the new and old. It features a modern high-gloss kitchen with an integrated oven and microwave, hob and extractor, as well as a washing machine. The dining area includes built-in seating with clever storage solutions and a door leading to the garden.

Rise up to the first floor, and you'll find two double bedrooms, both offering ample space and comfort. The spacious family bathroom is also located on this floor, designed with contemporary fittings to meet all your needs.

Outside, you'll find a private courtyard garden, providing a serene outdoor space perfect for relaxation. At the front, on-street parking is conveniently available. This enchanting cottage in Kedington is a perfect blend of modern living and classic charm, offering a cosy and comfortable home in a highly sought-after village location.

ENTRANCE HALL

LOUNGE 13' 5" x 11' 1" (4.09m x 3.38m)

KITCHEN/DINER 17' 10" x 6' 11" (5.44m x 2.13m)

LANDING

BEDROOM ONE 11' 1" x 10' 7" (3.4m x 3.25m)

BEDROOM TWO 8' 9" x 7' 8" (2.67m x 2.36m)

BATHROOM

Additional Information

Local Authority – West Suffolk Council

Council Tax Band – B

Tenure – Freehold

Services – Mains drainage, electric heating.

Post Code – CB9 7QJ

Viewings by appointment

Bychoice Estate Agents

Tel: 01440 768919



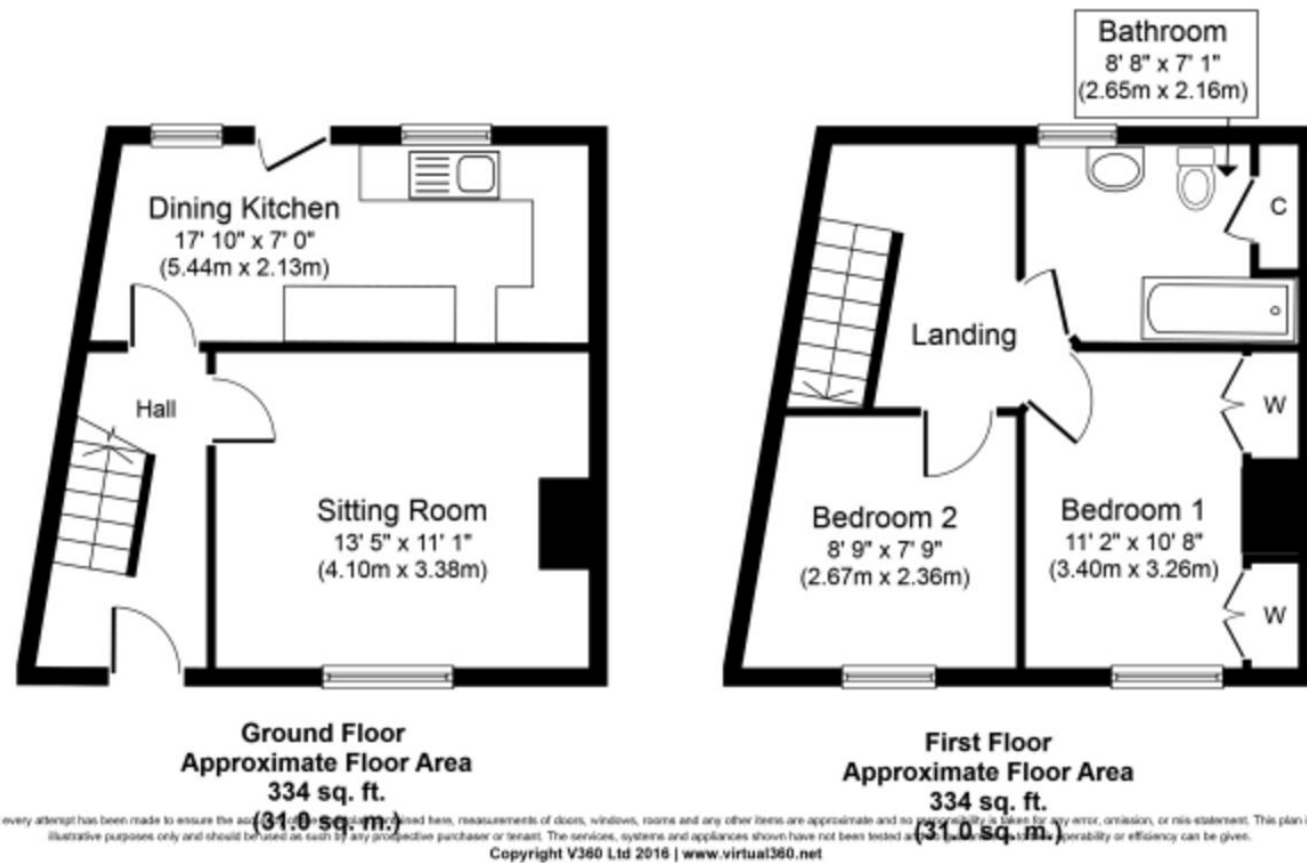

If you would like to speak to one of our mortgage advisors call now – 01440 768919



Your home may be repossessed if you do not keep up repayments on your mortgage.
EPC TO FOLLOW

Contact Details
27b High Street, Haverhill, Suffolk, CB9 8AD
Tel: 01440 768919
Email: haverhill@bychoice.co.uk

Agents Note: Whilst every care has been taken to prepare these sales particulars, they are for guidance purposes only. All measurements are approximate and for general guidance purposes only and whilst every care has been taken to ensure their accuracy, they should not be relied upon and potential buyers are advised to recheck the measurements

Prospect Terrace | Kedington | CB9 7QJ

This beautiful cottage is situated in the heart of the popular village of Kedington, perfectly blending modern amenities with a wealth of character and charm. With two double bedrooms, the property has been lovingly improved including stunning double glazed sash windows & new energy efficient electric radiators.

£285,000

- NO ONWARD CHAIN
- BEAUTIFUL COTTAGE
- SITUATED IN THE HEART OF KEDINGTON
- REPLACEMENT DOUBLE GLAZED SASH WINDOWS
- BEAUTIFUL BLEND OF CHARACTER CHARM WITH MODERN FEATURES
- MODERN ENERGY EFFICIENT ELECTRIC RADIATORS
- FEATURE FIREPLACE WITH LOG BURNER