



Pipistrelle Way | Great Wheltenham | IP30 0BF

Shared Ownership £153,000

Located in the village of Great Wheltenham, just outside of Bury St Edmunds is this 2 bedroom semi detached home being offered at 60% share. The property boasts off road parking, kitchen/diner, ground floor cloakroom & garden.

- 2 Bedrooms
- Solar Panels
- Off Road Parking
- Garden
- Ground Floor Cloakroom
- Modern Home
- 60% Shared Ownership

Approximate Room Sizes

ENTRANCE HALL

GROUND FLOOR WC

KITCHEN 12' 0" x 12' 0" (3.66m x 3.66m)

LOUNGE 17' 0" x 9' 02" (5.18m x 2.79m)

FIRST FLOOR LANDING

MASTER BEDROOM 17' 0" x 9' 02" (5.18m x 2.79m)

BEDROOM 2 10' 02" x 12' 01" (3.1m x 3.68m)

FAMILY BATHROOM

AGENTS NOTE Full Market Value - £255,000

Share – 60% - £153,000

Rent – £296.23

Service Charge - £27.88pcm

Leasehold Property with 94 years remaining on the lease

Local Authority – West Suffolk Council

Council Tax Band – B

Tenure – Leasehold

Post Code – IP30 0BF

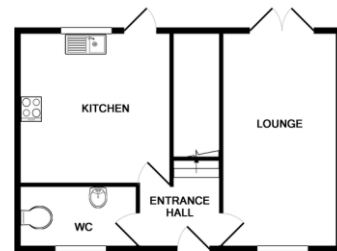

GROUND FLOOR



1ST FLOOR

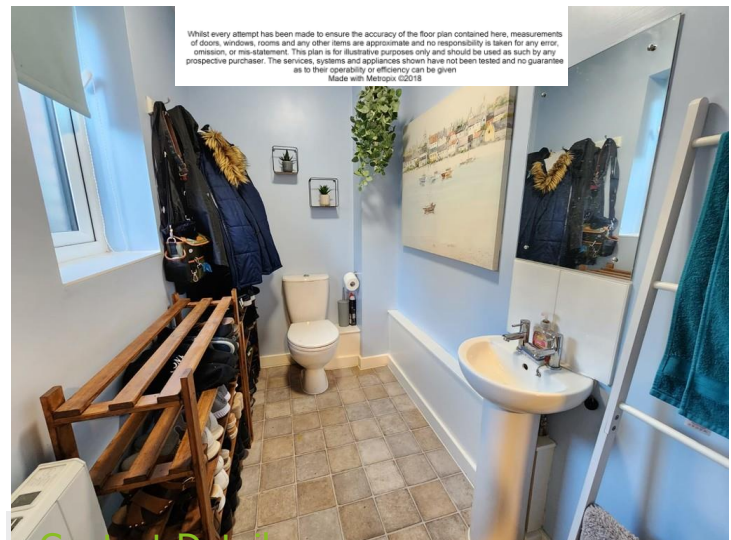

Whilst every attempt has been made to ensure the accuracy of the floor plan contained here, measurements of doors, windows, rooms and any other items are approximate and no responsibility is taken for any error, omission, or mis-statement. This plan is for illustrative purposes only and should be used as such by any prospective purchaser. The services, systems and appliances shown have not been tested and no guarantee as to their operability or efficiency can be given.
Made with MettPix ©2018

Contact Details

6 The Traverse, Bury St Edmunds, IP33 1BJ

Tel: 01284 769598

Email: burystedmunds@bychoice.co.uk

Agents Note: Whilst every care has been taken to prepare these sales particulars, they are for guidance purposes only. All measurements are approximate and for general guidance purposes only and whilst every care has been taken to ensure their accuracy, they should not be relied upon and potential buyers are advised to recheck the measurements

