

Bychoice

ESTATE AGENTS



Flat 7, John Howe Court, Gaol Lane, Sudbury, Suffolk

£950

Property Summary

Available April! This modern 1 bedroom apartment in Sudbury's town centre, with open plan kitchen and lounge, integrated hob, oven. Modern bathroom with shower over bath and spacious bedroom.

- Modern Apartment
- Large Bedroom
- Open Plan Kitchen & Lounge
- Bathroom with Shower
- Private Entrance
- Gas Central Heating

Available April! This modern 1-bedroom apartment in Sudbury's town centre, with open plan kitchen and lounge, integrated hob, oven. Modern bathroom with shower over bath and spacious bedroom.

AGENT NOTE

Unfortunately, this landlord does not accept pets.

Limited un-allocated parking available.

ENTRANCE HALL

UPVC front door

KITCHEN/LOUNGE

Open plan, range of matching wall and base units with work surface over hob and oven, sink with drainer, UPVC window.

BEDROOM

Spacious bedroom, radiator, UPVC window.

BATHROOM

White bathroom suite with panelled bath and shower over, toilet, hand basin, radiator.

GROUND FLOOR
446 sq.ft. (41.4 sq.m.) approx.

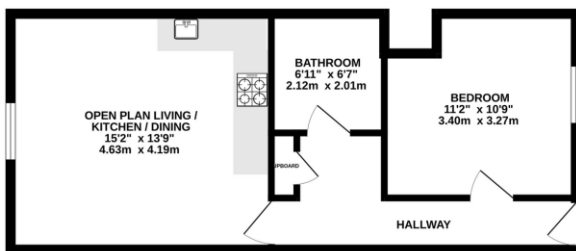

TOTAL FLOOR AREA: 446 sq ft. (41.4 sq.m.) approx.
*All measurements have been made to ensure the accuracy of the finished completed area, measurements of walls, windows, doors and any other items are approximate and no responsibility is taken for any error, omission or misstatement. This plan is for guidance purposes only and should not be used as a basis for any prospective purchase. The accuracy, quantity and quality of these measurements are not guaranteed and no guarantee is given for their accuracy or efficiency can be given.
*See web reference 02020

Additional Information

Tenure:

Council Tax Band:

Local Authority: Babergh District Council

Post Code: CO10 1JL

Viewings by appointment only

Tel: 01787 468408

Email: sudbury@bychoice.co.uk

Bychoice
ESTATE AGENTS



Agents Note: Whilst every care has been taken to prepare these sales particulars, they are for guidance purposes only and whilst every care has been taken to ensure their accuracy, they should not to be relied upon and potential buyers are advised to recheck the measurements.