



£375,000

Meadow Cottage, Mill Hill



THE PROPERTY

Believed to date back to the 19th Century, Meadow Cottage is a charming brick and flint property with part-rendered elevations beneath a slate roof. Originally part of 'The Windmill', once a prominent landmark at the village's edge, the cottage and surrounding buildings have since been thoughtfully converted for residential use. The home benefits from gas central heating, UPVC double glazing, and offers an entrance hall, open-plan living room/kitchen, three bedrooms (one with ensuite), and a bathroom. Externally, there is off-road parking for two vehicles and a south-facing, enclosed rear garden. Accessed via a shared gravel drive, it enjoys a peaceful setting on the outskirts of the village.

THE LOCATION

Nestled in the heart of Suffolk, Lavenham is a picture-postcard village famed for its rich medieval heritage and timber-framed architecture. Once a thriving wool town, its streets are lined with historic buildings, including the iconic Guildhall, creating a timeless atmosphere that attracts both residents and visitors alike.

The village offers excellent amenities: traditional pubs, acclaimed restaurants (including the Swan Hotel), tea rooms, local shops, and a vibrant community spirit. There's a highly regarded primary school, a doctor's surgery, and a monthly farmers' market showcasing local produce and crafts.

Lavenham is surrounded by beautiful countryside, ideal for walks such as the scenic railway trail to Long Melford. Highlights include the famed De Vere House—known as the 'Harry Potter House'.

More than just a place to live, Lavenham offers a lifestyle steeped in history, beauty, and community charm.







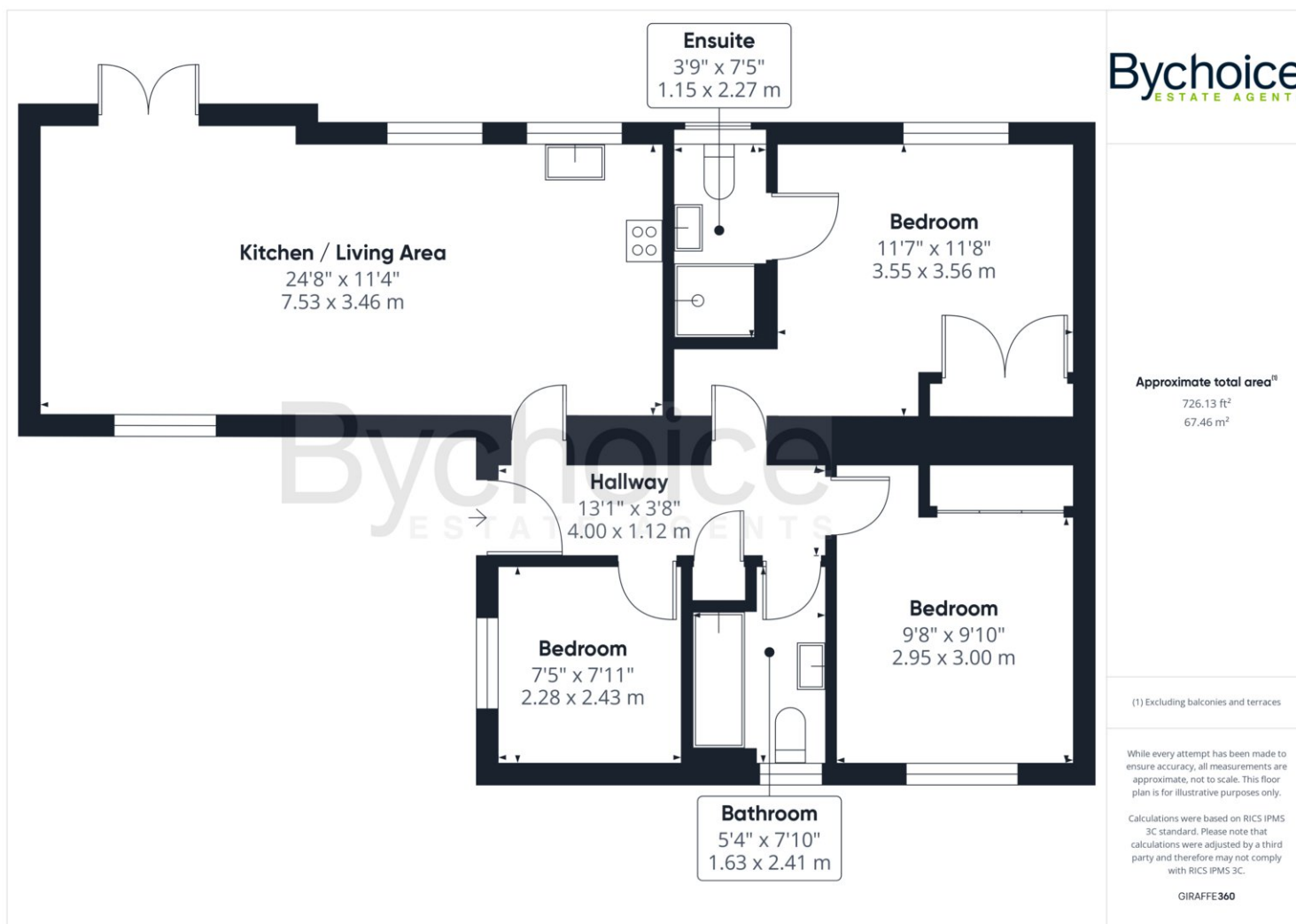

Council & Council Tax Band – Band C -
Babergh District Council

Tenure – Freehold

Property Construction – Brick & Flint
construction

Utilities – Mains Water, Mains Electric,
Mains Drainage, Gas Central Heating

Broadband - Superfast broadband with
downloads speeds of up to 43Mbps and
upload speeds of up to 8Mbps (Ofcom
data)

Mobile Coverage - Voice & Data likely with
EE, Three, O2 & Vodaphone. (Ofcom data)

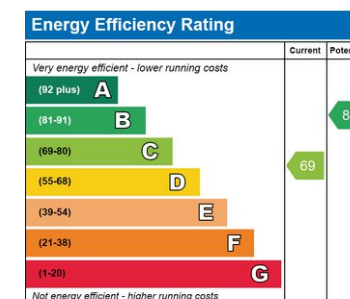

Sudbury Office
01787 468400
sudbury@bychoice.co.uk
6, King Street, Sudbury, Suffolk, CO10 2EB

Agents Note: Whilst every care has been taken to prepare these particulars, they are for guidance and are for general guidance purposes only and whilst every care has been taken to ensure their accuracy, they should not be relied upon.

Bychoice
ESTATE AGENTS