



£260,000

7 Bailey Lane



The Property

This charming two-bedroom bungalow features a welcoming hallway leading to all rooms. The spacious sitting/dining room benefits from natural light, while the stylish kitchen offers wooden worktops, ample storage, integrated appliances, and direct access to the rear garden. A separate utility room provides extra storage and space for white goods.

The front-facing main bedroom is well-proportioned with a large window, while the rear second bedroom is equally spacious and bright. The modern bathroom includes a bath with an overhead shower, toilet, and sink.

Outside, the rear garden combines patio and lawn, ideal for relaxing or entertaining. An outbuilding offers extra storage, and residents' parking is available.

The Location

Clare, a picturesque Suffolk market town, is rich in history and amenities. Its charming streets are lined with historic timber-framed buildings, while Clare Castle and Clare Country Park offer scenic walks and leisure spaces.

The town boasts local shops, cafes, schools, and healthcare facilities, ensuring convenience for residents. For further amenities, Sudbury (7 miles) and Bury St. Edmunds (20 miles) provide additional shopping, dining, and cultural attractions.







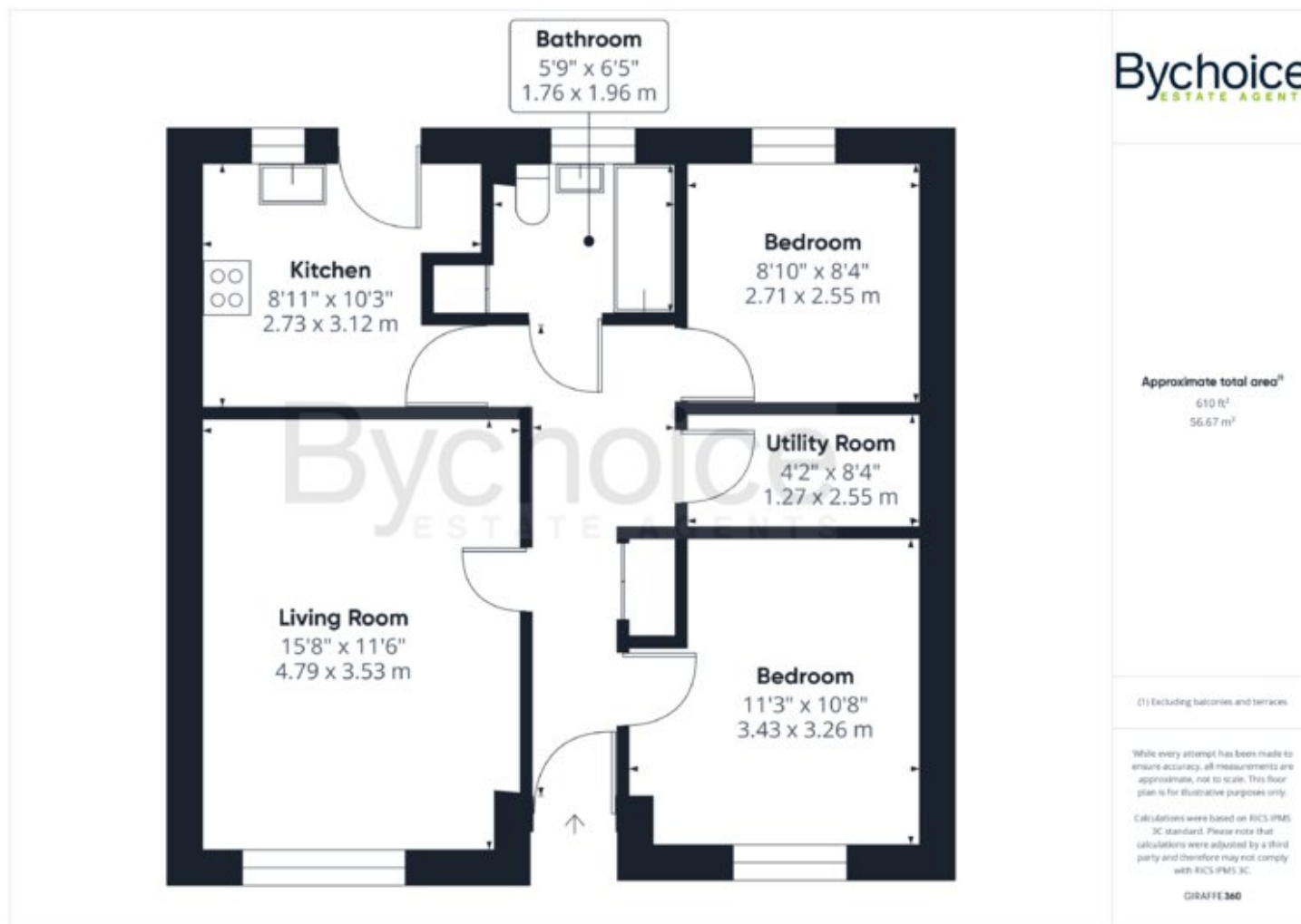

Council & Council Tax Band – Band B -
West Suffolk Council

Tenure – Freehold

Broadband – Ultrafast broadband with
downloads speeds of up to 1000 Mbps
and upload speeds of up to 1000 Mbps
(Ofcom data)

Mobile Coverage – Voice & Data likely
with EE, Three, O2 & Vodafone.
(Ofcom data)

Utilities – Mains Water, Mains Electric,
Mains Drainage, Gas Central Heating

Property Construction – Brick
Construction

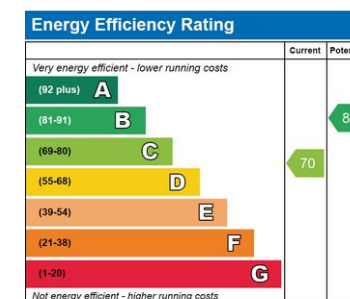

Sudbury Office
01787 468400
sudbury@bychoice.co.uk
6, King Street, Sudbury, Suffolk, CO10 2EB

Agents Note: Whilst every care has been taken to prepare these particulars, they are for guidance and are for general guidance purposes only and whilst every care has been taken to ensure their accuracy, they should not be relied upon.

Bychoice
ESTATE AGENTS