



£210,000

**Chequers Park, Whatfield Road, Elmsett,
Ipswich, Suffolk**



The Property

This well-presented two-bedroom park home offers thoughtfully designed, open plan living ideal for modern lifestyles. The entrance hall leads to a spacious living/kitchen/dining area, filled with natural light from a front-facing window and French doors to the rear garden.

The kitchen includes built-in appliances, inset sink, space for white goods, and ample storage. The main bedroom benefits from a walk-in dressing room and en suite with shower, WC, and vanity unit. Bedroom two includes a built-in wardrobe, while the main bathroom features a walk-in shower, WC, and under-sink storage.

Set on a double plot, the low-maintenance rear garden is laid to patio and stone, with a summer house ideal for relaxing or entertaining. A garage and driveway complete the offering.

The Location

Elmsett is a charming Suffolk village offering local amenities, a strong community, and easy access to Ipswich, Bury St Edmunds and Colchester—perfect for peaceful living with modern convenience.







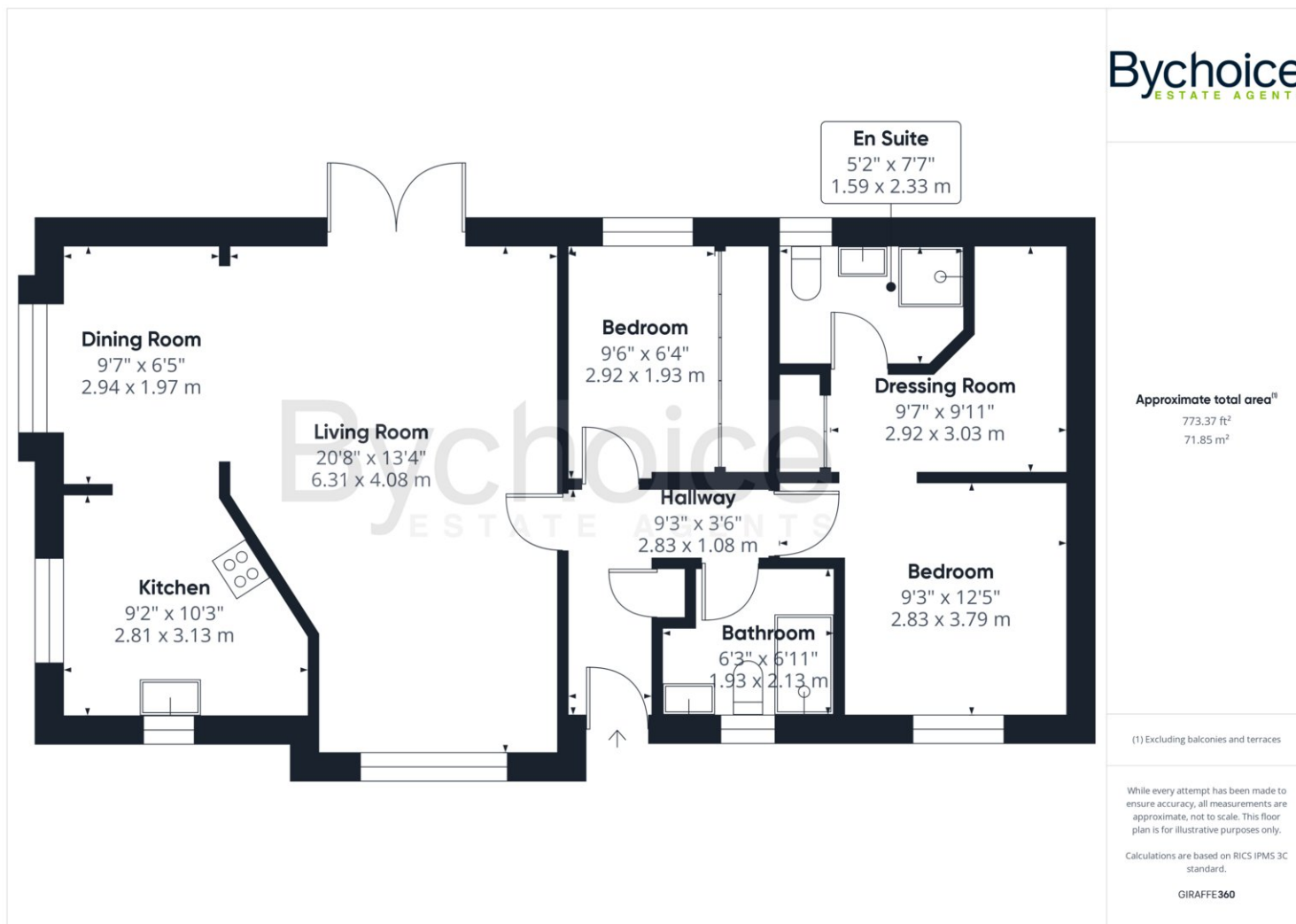

Council & Council Tax Band – Band A - Babergh District Council

Service Charge – TBC

Ground Rent – TBC

Broadband – Superfast broadband with downloads speeds of up to 46 Mbps and upload speeds of up to 8 Mbps (Ofcom data)

Mobile Coverage – Voice & Data likely with EE, Three, O2 & Vodafone. (Ofcom data)

Utilities – Mains Water, Mains Electric, Mains Drainage, Gas Central Heating

Property Construction – A timber frame is created using wooden studs. This is combined with interior walls made from plasterboard and external cladding

Site Rules - No more than two dogs or no more than two cats or one dog or one cat. No more than two cars can be parked per plot and no storage for a caravan or motor home.

Sudbury Office
01787 468400
sudbury@bychoice.co.uk
6, King Street, Sudbury, Suffolk, CO10 2EB

Agents Note: Whilst every care has been taken to prepare these particulars, they are for guidance and are for general guidance purposes only and whilst every care has been taken to ensure their accuracy, they should not be relied upon.

Bychoice
ESTATE AGENTS